

# PRANSA RING 120

LED\_Panel family

IP20

IK03



T<sub>a</sub>25 **5**



**THE FAMILY OF SURFACE AND PENDANT MOUNTED PANEL OPERATING AT 120W, 220-240 VAC INPUT. DELIVERING OUTSTANDING PERFORMANCE OF 12000L**

## Technical description

Luminaire was designed to be used white LEDs for illumination purposes can be surface and pendant mounted, Wide and uniform light distribution for decorative application. Down light luminaire with 120 w, 3000-4000-6000 kelvin LEDs for indoor applications. Robust luminaire housings made from aluminum. Diffuser is polystyrene. All LEDs are within a three step Macadam ellipse to ensure color consistency. Energy saving is up to 90% in comparison with traditional light sources. Can be fitted as pendant or surface luminaire using special accessory.

Standard Diameters: 60 & 90 & 120cm



## Application

- Office
- Education
- Exhibition
- Hospital

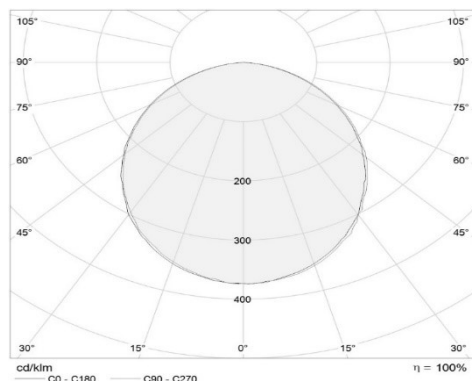

Correlated color temperature: 3000-4000-6000 kelvin  
 Rated median useful life: 50000h L70 at 25°C  
 Luminaire input power: 120w

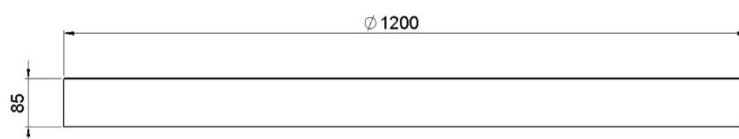

Dimensions: Φ1200 x 85mm  
 Total power: 120w  
 Luminaire luminous flux: 12000lm  
 Luminaire efficacy: 100 lm/w  
 Weight: 6.5kg

## Mounting and installation

Recessed, Surface and pendant mounting with special accessories to be ordered